

30mm WALLDRAIN PANEL

STANDARD DUTY 550



Walldrain provides a permanent, structural and non-clogging void between the building structure and the soil profile that will not collapse or distort. Ideal for vertical drainage applications like basements and retaining walls, Walldrain panels come pre-wrapped with filter fabric for fast installation.

TECHNICAL DATA

Dimensions (Metric):	(H) 30mm x (L) 1100mm x (W) 1100mm
Dimensions (Imperial):	(H) 1.18" x (L) 43.3" x (W) 43.32"
Weight:	2.6kg/sqm (0.53lb/1ft ²)
Surface Void:	>65%
Compressive strength:	80t/m ² (113.8 PSI)
Flow Rate:	14,400 litres/h/sqm @ 1% fall (508.5/h/ft ²)
Service temperature:	-30°C + 120°C (-22°F + 248°F)
Material:	Available in Reprolene™ (Recycled Polypropylene) or HDPE
Chemical properties:	Unaffected by moulds and algae, soil-bourne chemicals and bacteria

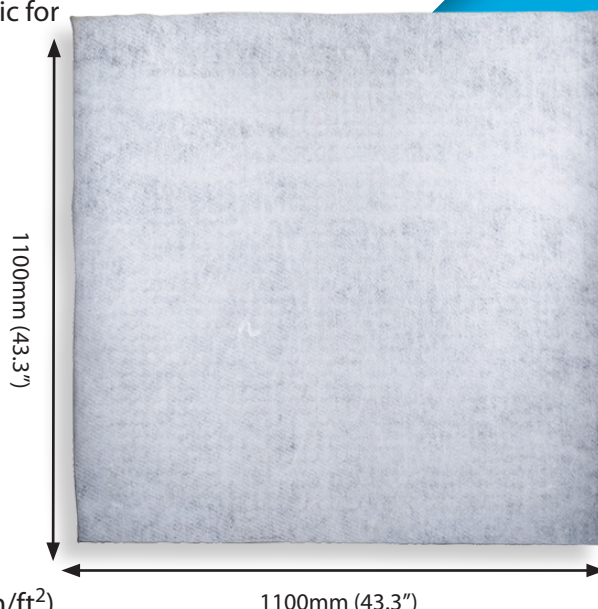

APPLICATIONS	FEATURES	BENEFITS
Planter boxes	High compressive strength	Trafficable
Roof gardens	Open structure	High flow rate
Podiums	Durable	Long life expectancy
Retaining walls	Lightweight	Easy to handle
Civil works	Supplied in large panels	Quick to install
Sports fields	Superior quality	Chemical and bacteria resistant
Under slab drainage	Made from recycled plastic	Environmentally friendly

DISCLAIMER:

All reasonable care has been taken in compiling the information in this brochure. The details in this brochure are intended only as a guide in specifying and installing.

Ausdrain™ products. It is the customers responsibility to ensure that each product is suitable for its intended purpose and that the actual conditions of use are suitable. AUSDRAIN™ assumes no responsibility for the specification and/or installation of its products or for improper reliance upon or misuse of the data herein. Due to continuous product development AUSDRAIN™ reserves the right to change product design and/or specifications without notice.

Australian Drainage Modules Pty Ltd trading as AUSDRAIN™

WALLDRAIN INSTALLATION PROCEDURE



1. Start by laying the drainage pipe at the base of the wall and connect to a stormwater outlet. Either a slotted pipe or ag line with filter sock is suitable.
2. Ensure that the surface of the wall has been waterproofed to prevent moisture from penetrating the wall.
3. Place the pre-wrapped Walldrain panel above the drainage pipe and fix to the wall with Sikaflex or a compatible polyurethane based adhesive.
Note:
 - It is recommended to cut some slits in the fabric at the bottom edge of the panel so water can easily flow to the drainage pipe.
 - If the panels need to be cut to size, start by cutting the fabric away from the panel and then cut the plastic drainage cell with a saw or angle grinder.
 - Timber props may also assist to hold the panels in place.
 - Do not penetrate the waterproofing with any fixings.
4. Continue to fix the adjacent panels along the length of the wall. If the last panel requires cutting on the vertical edge ensure that geotextile is used to cap off the edge of the panel.
5. Once the first layer of Walldrain panels has been fixed, backfill the drainage pipe with 300mm of coarse washed river sand to the base of the wall.
Note:
 - It is important not to backfill the drainage pipe with soil or blue metal as the fines can block the filter sock.
6. Continue to backfill with clean granular material against the Walldrain Panels.
7. For higher walls place and fix the next layer of Walldrain Panels (Repeat Step 3).
8. Continue installing and backfilling the Walldrain Panels until the required height has been achieved.

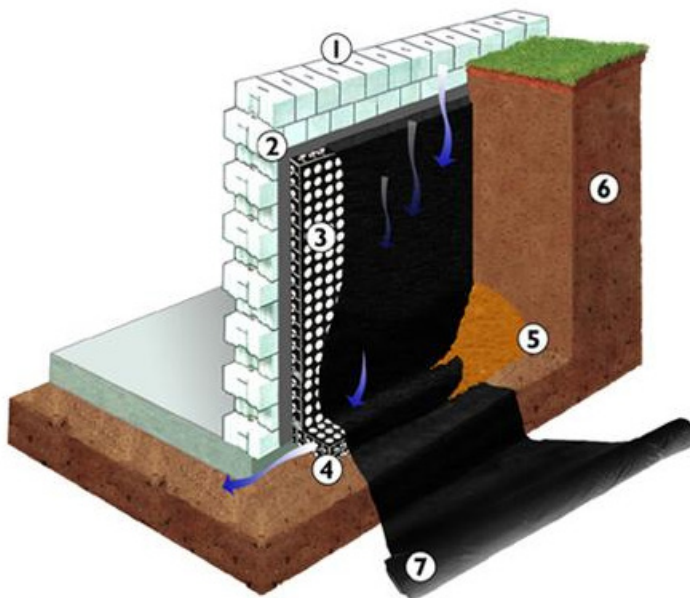

INSTALLATION COMPONENTS

1. Waterproof membrane
2. Ausdrain Protection board
3. Ausdrain 30mm WallDrain Panel
4. Strip drain
5. Coarse washed river sand
6. Soil mix
7. Geotextile fabric

DISCLAIMER:

All reasonable care has been taken in compiling the information in this brochure. The details in this brochure are intended only as a guide in specifying and installing.

Ausdrain™ products. It is the customers responsibility to ensure that each product is suitable for its intended purpose and that the actual conditions of use are suitable. AUSDRAIN™ assumes no responsibility for the specification and/or installation of its products or for improper reliance upon or misuse of the data herein. Due to continuous product development AUSDRAIN™ reserves the right to change product design and/or specifications without notice.

Australian Drainage Modules Pty Ltd trading as AUSDRAIN™